

# GAS WELL PERMITTING



## Various Towns/Cities/Counties

Project components include extensive coordination between our surveying and engineering teams, administrative staff, governmental officials and our client to obtain permits to drill natural gas wells on private and public land. Scope of work includes deed research, topographic and boundary surveys, preparation of mineral lease surveys, well permit plats and submission of gas drilling permit documents. Other related engineering activities include preparation and submittal of grading and drainage plans, erosion control plan, SWPPP documents and landscaping screening features to obtain final approval to drill.

**JEA HydroTech** has been successful in obtaining Specific Use and Gas Well Drilling Permits in the following cities:

- Arlington
- Keller
- North Richland Hills
- Mansfield
- Grand Prairie
- Midlothian
- Fort Worth
- Bartonville.

Our pipeline surveying and easement work covers the counties of Bosque, Hill, Johnson, Tarrant, Parker, Wise, Dallas, Collin, Ellis, Hood, McLennan and Somervell.

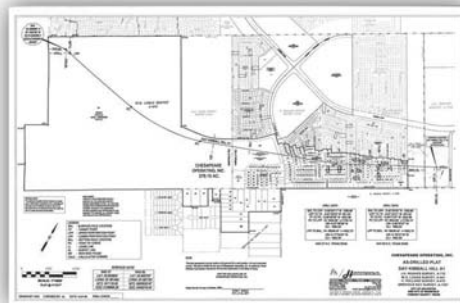



#### **Day Kimball Hill #A1 Natural Gas Well Site - Arlington, TX**

JEA HydroTech Engineering & Surveying was instrumental in the Permitting Process for the Day Kimball Hill #A1 in south Arlington. Scope of work included deed research, topographic and boundary surveys, preparation of unit designations, well plats and submission of gas drilling permit documents. Other related activities included preparation and submittal of grading and drainage plans, erosion control plan, SWPPP documents and landscaping features to obtain final approval to drill. Project components included extensive coordination between our surveying and engineering teams, administrative staff, the City of Arlington, initial leaseholders ExxonMobil and Harding Energy Partners and later Chesapeake Energy, to obtain permits to drill natural gas wells on the Day Kimball Hill site.

JEA HydroTech is very pleased to have been involved from inception to completion of the Barnett Shale's most productive gas well.



#### **Black Gas Well Unit – Keller, TX**

Project consisted of urban boundary surveys of more than 30 subdivisions for inclusion in the overall boundary of the Black Gas Well Unit located south of the City of Keller Municipal Annex at the intersection of Rufe Snow Drive and F.M. 1309 in Keller, Tarrant County. Deed and Right-of-Way documents were reviewed and analyzed from present back to the original patents from the State of Texas. Lease areas were defined by strips and gores doctrine and parent deeds in boundary analyses. Boundary surveys were performed to determine Lease areas created in public rights-of-way which were than described by metes and bounds. Also included were graphic exhibits which were prepared and submitted to the General Land Office for review and recordation with the State. Performed extensive topographic surveys were to provide current data required by the City of Keller and the Texas Railroad Commission for permitting, flood way determination, tree location and other essential purposes. The time frame to complete this project was approximately six (6) months. Submittals included two (2) unit plats with field notes, two (2) well plats, two (2) pad site surveys and two (2) surface use plats.